

SELECTION OF PUMP SIZE

The selection of the size of a positive displacement pump depends to a great extent on the viscosity of the product to be pumped and its shear sensitivity. The diagram shows the capacity range of the pump but for certain products, particularly high viscosity products, a larger pump with a lower speed must be selected. Contact your local representative for information regarding the correct pump size.

The following data must be known in order to select the correct pump size and drive unit:

- Product to be pumped
- Required capacity (or capacity range)
- Required pressure (or pressure range)
- Density of the product
- Viscosity of the product
- Operating temperature of the product
- Max. temperature of medium to be pumped
- Type of connection – any standard thread or flange can be fitted
- Optional equipment
- Voltage frequency

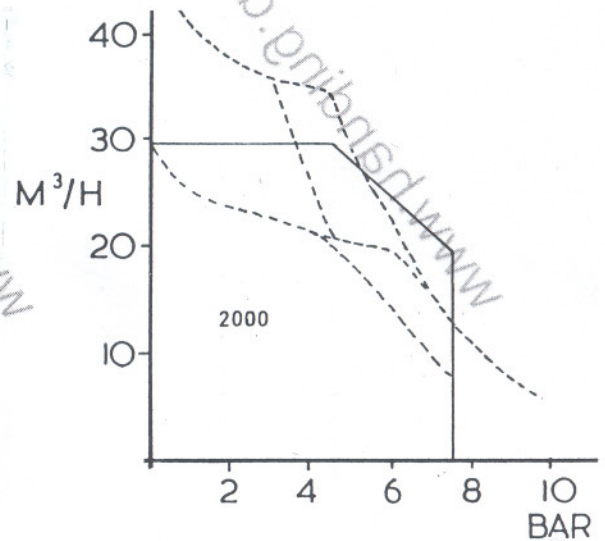

The basic selection graph shows only the operating parameters of the pump and should only be used as a guide. Any dimensions shown below were correct at time of going to press but are subject to change, certified drawings are available on request.

Model

2030

Connection

75.0 mm (3")

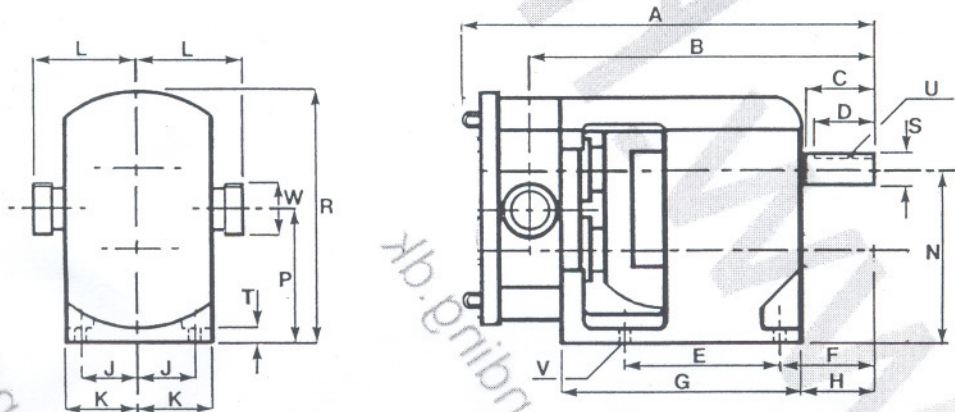

	A	B	C	D	E	F	G	H	J	K	L	N	P	R	S	T	U	V	W	Weight	Oil
2000 ⁽¹⁾	450	370	80	40	182.5	99.3	255	85	72.5	87.5	115 117	190	143.5	280	K6 38	16	10×5-0	12	2" 3"	55Kg	1-7lt



Handing ApS

Nordkranvej 5-9, Vassingerød
DK - 3540 Lyngge
Tel.: +45 48160166
www.handing.dk

IBEX MOG 2020

Dette dokument er vejledende.
Der tages forbehold for fejl.
This document is only guiding.
We make reservation for possible errors.

Tegn. Godk.TN

Lager nr.

PT2008